



Model No : TLY-MB-A-4XK-0D-01

Spec No.	Date	Page	Ver.
/	Feb/18/2016	1/7	A2

Jiang Xi TALOYA Technology CO. LTD.

SPECIFICATION FOR APPROVAL

Company Name: _____

Product Name: LED Round Panel Light

Part No: TLY-MB-A-4XK-0D-01

Description: AC100-240V 50/60Hz

Your Part No: _____

For customer filling			
Confirmed department.			
Confirmed result			
(Signature)			
Finally result			

Approve	Auditing	Make
Hailin Zhou	Haimin Guo	Martin Liu

SHENZHEN Add:
613, Huanancheng Development Center, Pinghu St., Longgang Dist., Shenzhen,
Guangdong, China (Mainland)
 TEL: 86-755-84669045 FAX: 86-755-84573610 Email: tw@taloya.cn www.taloya.com

Spec No.	Date	Page	Ver.
/	Feb/18/2016	2/7	A2

Product Description

- ◆ Energy saving—Have constant current driver, ultra-low power consumption, high efficiency
- ◆ Environmental—No UV & infrared radiation, Light without the heat, more soft light.
- ◆ Super bright—Use high bright LED, vertical illuminance is exceed to other factory's.
- ◆ Long life—Up to more than 20,000 hours.
- ◆ Attractive appearance—With bright appearance, non-pollution and slim and light, easily installed without fixed holder

Product Picture



Product Dimensions

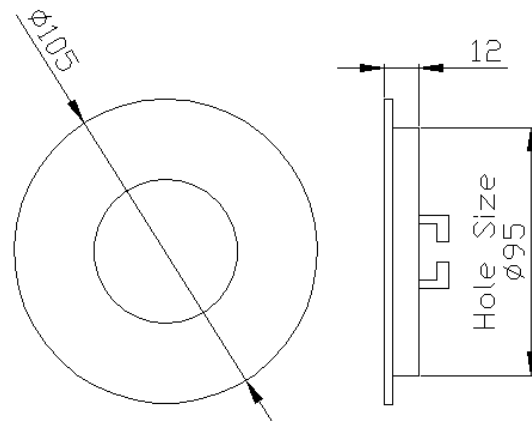

Application area

It can totally replace fluorescent lamp, applications in various areas of lighting. Such as hotels, bars, supermarkets, restaurants, museums, exhibition halls, conference room, shops, warehouses, home lighting and other places.

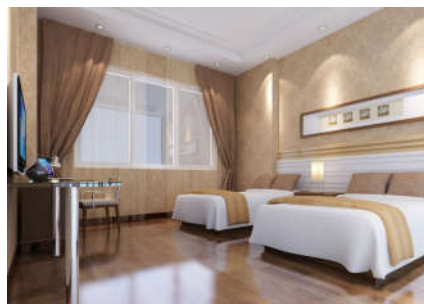
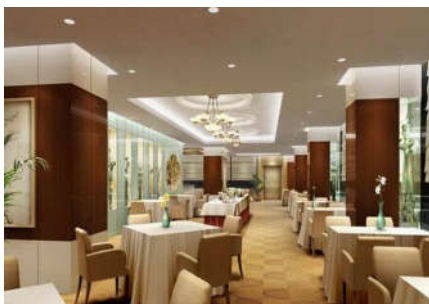

Average illumination figure

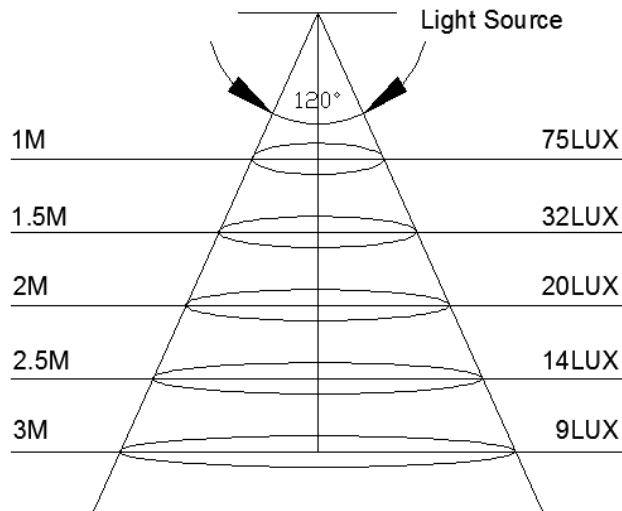

Device Selection Guide

Part No.	Color	Dom. Wavelength or CCT(Typ.)	Lumen		LED Type
			Typ.	Max	
TLY-MB-A-4CK-0D-01	Cool white	6500K	290	350	SMD 2835
TLY-MB-A-4WK-0D-01	Warm white	3000K	290	350	SMD 2835

Note: [1] If you have any special request, please contact with our salesmen.

Technical Parameter at $T_A=25^{\circ}\text{C}$

Items	Symbol	Min.	Typ.	Max.	Units
Power Consumption	P	3.7	4	4.5	W
Single loop input Voltage (AC) ^[1]	V_i	100	---	240	V
Single loop input current (AC) ^[1]	I_f	25	---	70	mA
Viewing Angle	VA	115	120	125	Deg.
Surface Temperature in Operation Condition	/	-20	---	40	$^{\circ}\text{C}$
Surface Temperature in Storage Condition	/	-40	---	55	$^{\circ}\text{C}$
Lifespan	H	---	20000	---	H

Note: [1] It is recommended to use the typical input voltage to drive LED light. The unsuitable input voltage will damage the LED light or reduce the life of product.

Spec No.	Date	Page	Ver.
/	Feb/18/2016	4/7	A2

Integrating sphere test data

◆ Cool white

LED Test Report

Product Mark

Product Type : TLY-MB-A-4CK-0D-01	Manufacturer : TALOYA
Temperature : 'C	Humidity : 25%
Operator : Martin	Test Date : 2015-09-08

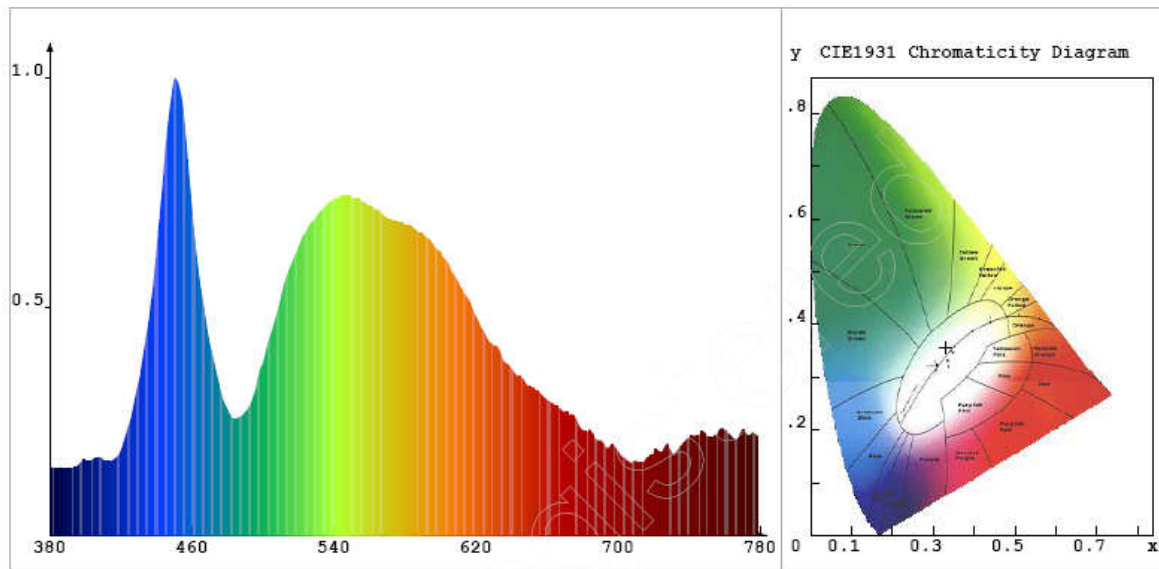

Chroma Parameters

Chro.Coor.: x=0.3311 y=0.3559 u=0.2004 v=0.3231 duv=0.0080
 CCT: Tc= 5560K Dominant Wave.: 550.5nm Purity: 6.2%
 R ratio: R= 13.7 Peak Wavelength: 450.9nm Half Width: 30.1nm

Rending Index: Ra= 78.0

R1 =74.4 R2 =81.3 R3 =86.3 R4 =77.3 R5 =74.9 R6 =75.0 R7 =88.3
 R8 =66.6 R9 =-4.0 R10=55.5 R11=73.4 R12=50.0 R13=75.6 R14=92.3
 R15=69.7

Photo Parameters

Flux: 311.64lm Effi.: 74.2lm/W RadiantPower: 974.6mW

Ele. Parameters

Voltage:U=214.6V Current:I=0.033A
 Power:P= 4.2W Power Factor:PF=0.610

Instrument state

IntgeTime: 840.682ms VPeak: 14949 VDark: 1043
 Scan Range: 380-780nm

Spec No.	Date	Page	Ver.
/	Feb/18/2016	5/7	A2

◆ Warm white

LED Test Report

Product Mark

Product Type : TLY-MB-A-4WK-0D-01 Manufacturer : TALOYA
 Temperature : 25°C Humidity : 75%
 Operator : Martin Test Date : 2015-09-08

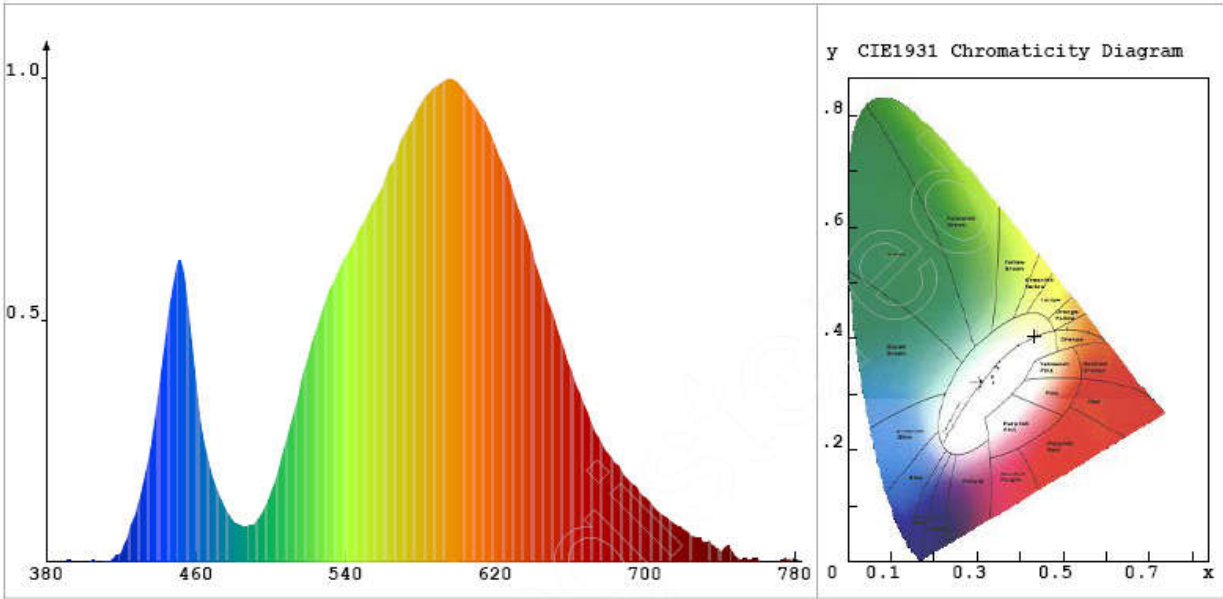

Chroma Parameters

Chro.Coord.: x=0.4324 y=0.4034 u=0.2479 v=0.3470 duv=0.0004
 CCT: Tc= 3072K Dominant Wave.: 583.4nm Purity: 50.9%
 R ratio: R= 20.9 Peak Wavelength: 594.2nm Half Width: 125.9nm

Rending Index: Ra= 71.9

R1 =69.4 R2 =80.7 R3 =89.1 R4 =68.4 R5 =66.6 R6 =70.8 R7 =80.6
 R8 =49.8 R9 =-21.8 R10=53.2 R11=61.5 R12=40.7 R13=71.3 R14=93.3
 R15=63.9

Photo Parameters

Flux: 300.94lm Effi.: 73.4lm/W RadiantPower: 938.6mW

Ele. Parameters

Voltage:U=218.0V Current:I=0.033A
 Power:P= 4.1W Power Factor:PF=0.610

Instrument state

IntgeTime: 238.855ms VPeak: 13597 VDark: 1317
 Scan Range: 380-780nm

Spec No.	Date	Page	Ver.
/	Feb/18/2016	6/7	A2

■ Connection

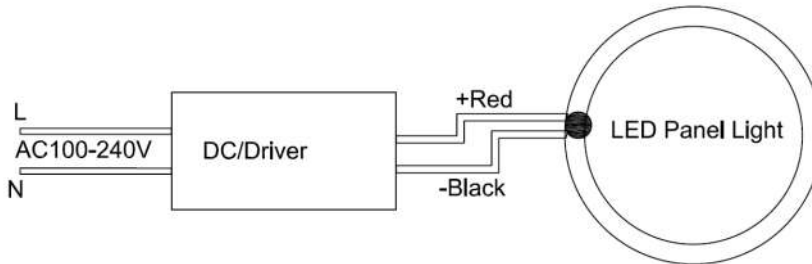

■ Installation Instruction

◆ **Attention:** Before installation, power must be cut off to keep people safe.

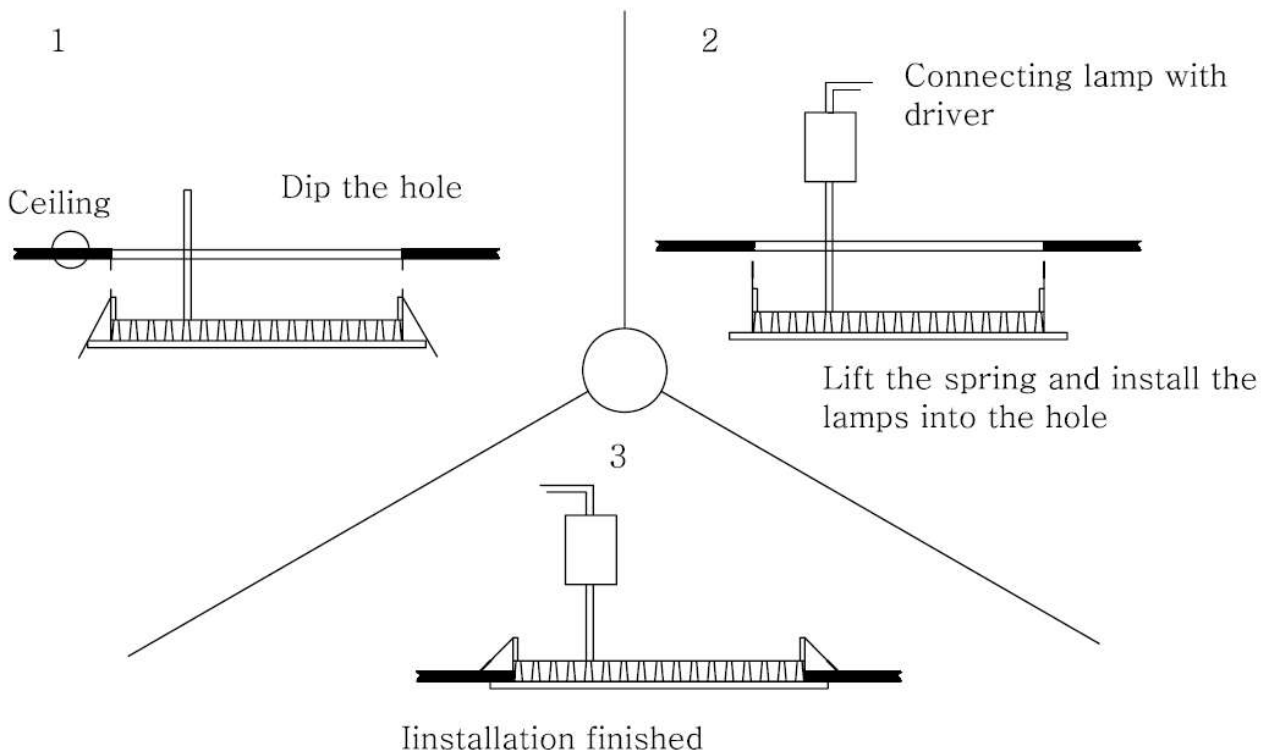

Notice: turn off the light before install or uninstall

Spec No.	Date	Page	Ver.
/	Feb/18/2016	7/7	A2

■ The view of package

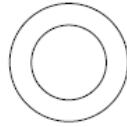

Panel light

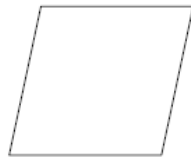

PE bag

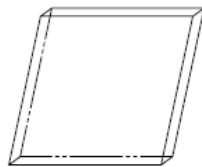

Inner box

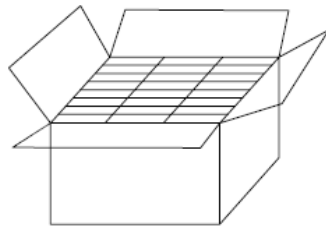

60pcs/Carton

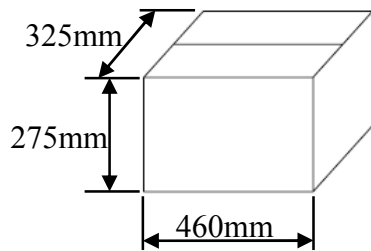

Sealed carton

Size of panel(mm)	∅ 105*12mm
Hole size(mm)	∅ 95mm
Inner box size	L*W*H: 120x28x150mm
Carton size	L*W*H: 460x325x275mm
Packing quantity	60pcs
Net weight	6.18kg
Gross weight	9.06kg