



Model No : TLY-MB-A-3XK-0D-01

Spec No.	Date	Page	Ver.
/	Feb/18/2016	1/7	A2

# Jiang Xi TALOYA Technology CO. LTD.

## SPECIFICATION FOR APPROVAL

Company Name: \_\_\_\_\_

Product Name: LED Round Panel Light

Part No: TLY-MB-A-3XK-0D-01

Description: AC100-240V 50/60Hz

Your Part No: \_\_\_\_\_

For customer filling			
Confirmed department.			
Confirmed result			
(Signature)			
Finally result			

Approve	Auditing	Make
Hailin Zhou	Haimin Guo	Martin Liu

SHENZHEN Add:

613, Huanancheng Development Center, Pinghu St., Longgang Dist., Shenzhen, Guangdong, China (Mainland)

TEL: 86-755-84669045 FAX: 86-755-84573610 Email: tw@taloya.cn www.taloya.com

Spec No.	Date	Page	Ver.
/	Feb/18/2016	2/7	A2

### Product Description

- ◆ Energy saving—Have constant current driver, ultra-low power consumption, high efficiency
- ◆ Environmental—No UV & infrared radiation, Light without the heat, more soft light.
- ◆ Super bright—Use high bright LED, vertical illuminance is exceed to other factory's.
- ◆ Long life—Up to more than 20,000 hours.
- ◆ Attractive appearance—With bright appearance, non-pollution and slim and light, easily installed without fixed holder

### Product Picture



### Product Dimensions

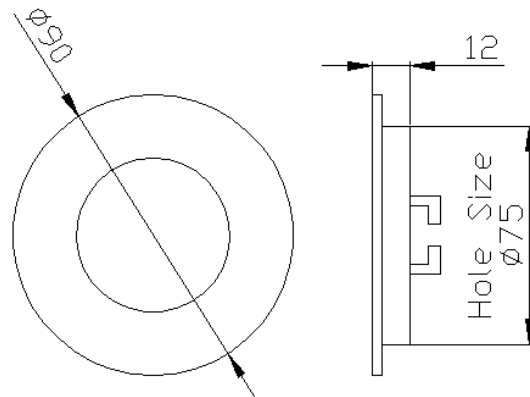

### Application area

It can totally replace fluorescent lamp, applications in various areas of lighting. Such as hotels, bars, supermarkets, restaurants, museums, exhibition halls, conference room, shops, warehouses, home lighting and other places.

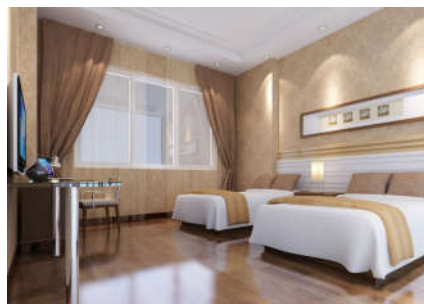
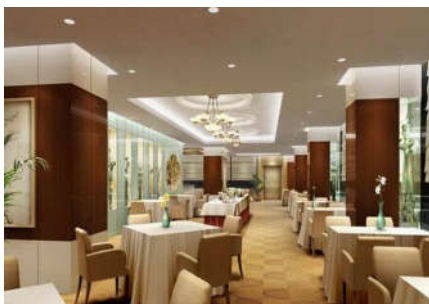

## Average illumination figure

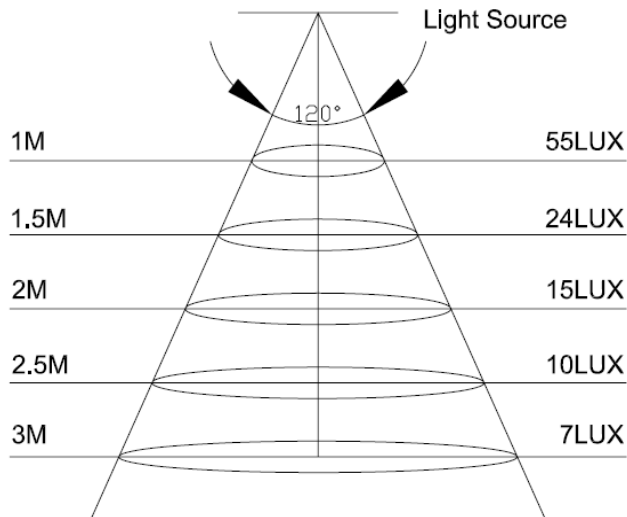

## Device Selection Guide

Part No.	Color	Dom. Wavelength or CCT(Typ.)	Lumen		LED Type
			Typ.	Max	
TLY-MB-A-3CK-0D-01	Cool white	6500K	210	250	SMD 2835
TLY-MB-A-3WK-0D-01	Warm white	3000K	210	250	SMD 2835

Note: [1] If you have any special request, please contact with our salesmen.

## Technical Parameter at T<sub>A</sub>=25°C

Items	Symbol	Min.	Typ.	Max.	Units
Power Consumption	P	2.8	3	3.5	W
Single loop input Voltage (AC) <sup>[1]</sup>	V <sub>i</sub>	100	---	240	V
Single loop input current (AC) <sup>[1]</sup>	I <sub>f</sub>	20	---	50	mA
Viewing Angle	VA	115	120	125	Deg.
Surface Temperature in Operation Condition	/	-20	---	40	°C
Surface Temperature in Storage Condition	/	-40	---	55	°C
Lifespan	H	---	20000	---	H

Note: [1] It is recommended to use the typical input voltage to drive LED light. The unsuitable input voltage will damage the LED light or reduce the life of product.

Spec No.	Date	Page	Ver.
/	Feb/18/2016	4/7	A2

## Integrating sphere test data

◆ Cool white

### LED Test Report

**Product Mark**

Product Type : TLY-MD-A-3CK-0D-01      Manufacturer : TALOYA  
 Temperature : 'C      Humidity : 25%  
 Operator : Martin      Test Date : 2015-09-08

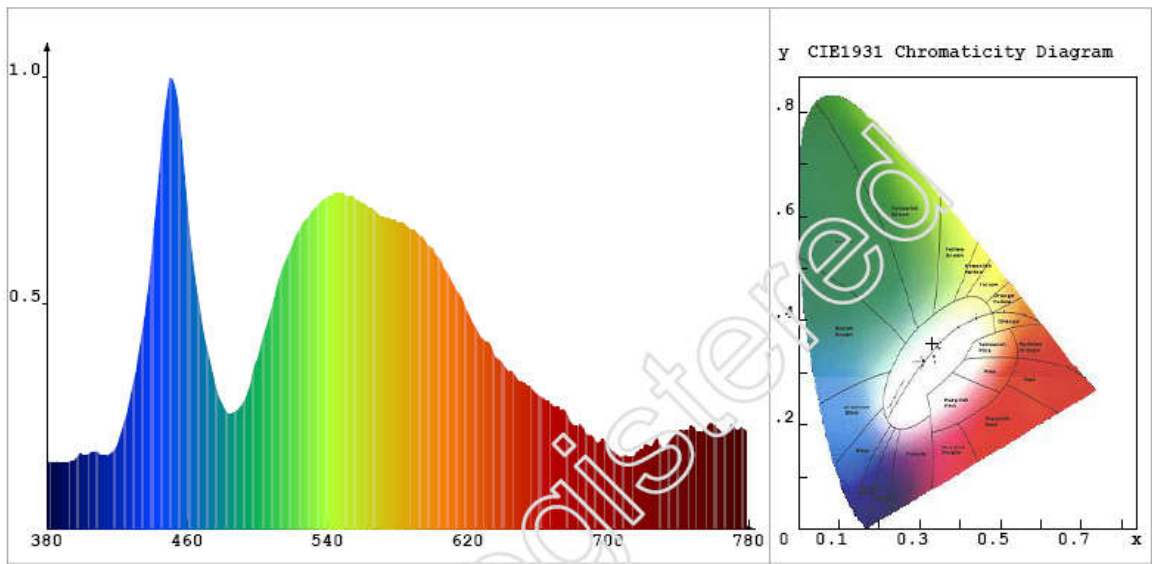

**Chroma Parameters**

Chro.Coor.: x=0.3311    y=0.3559    u=0.2004    v=0.3231    duv=0.0080  
 CCT: Tc= 5560K    Dominant Wave.: 550.5nm    Purity: 6.2%  
 R ratio: R= 13.7    Peak Wavelength: 450.9nm    Half Width: 30.1nm

**Rending Index: Ra= 78.0**

R1 =74.4    R2 =81.3    R3 =86.3    R4 =77.3    R5 =74.9    R6 =75.0    R7 =88.3  
 R8 =66.6    R9 =-4.0    R10=55.5    R11=73.4    R12=50.0    R13=75.6    R14=92.3  
 R15=69.7

**Photo Parameters**

Flux: 240.77lm    Effi.: 75.2lm/W    RadiantPower: 774.6mW

**Ele. Parameters**

Voltage:U=214.6V      Current:I=0.028A  
 Power:P= 3.2W      Power Factor:PF=0.610

**Instrument state**

IntgeTime: 840.682ms    VPeak: 14949      VDark: 1043  
 Scan Range: 380-780nm

Spec No.	Date	Page	Ver.
/	Feb/18/2016	5/7	A2

◆ Warm white

## LED Test Report

**Product Mark**

Product Type : TLY-MD-A-3WK-0D-01

Manufacturer : TALOYA

Temperature : 25'C

Humidity : 75%

Operator : Martin

Test Date : 2015-09-08

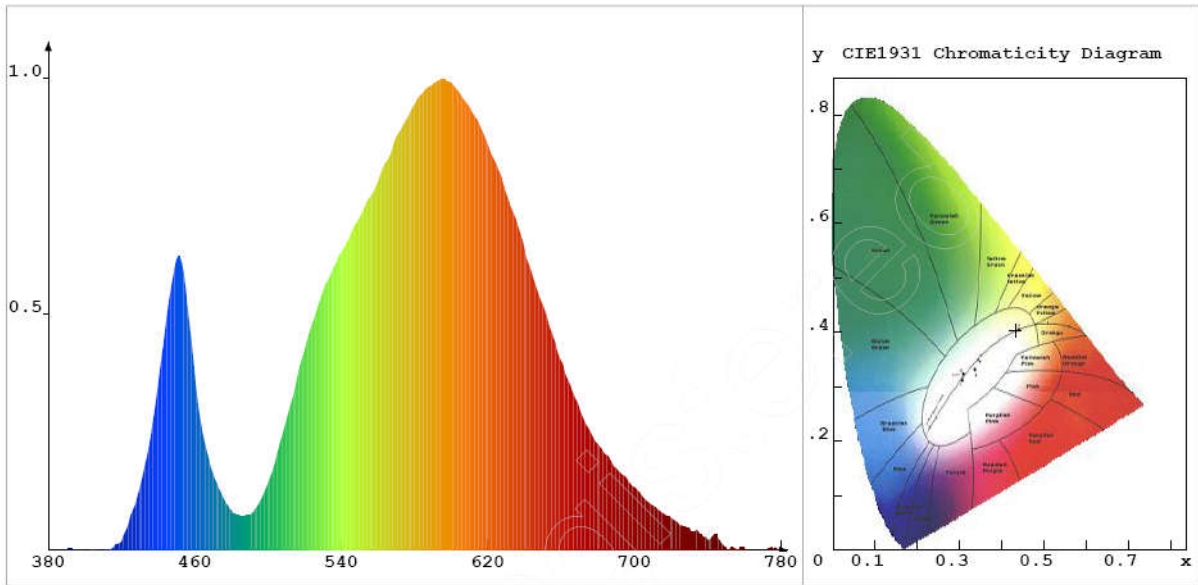

**Chroma Parameters**

Chro.Coor.: x=0.4324 y=0.4034 u=0.2479 v=0.3470 duv=0.0004

CCT: Tc= 3072K Dominant Wave.: 583.4nm Purity: 50.9%

R ratio: R= 20.9 Peak Wavelength: 594.2nm Half Width: 125.9nm

**Rending Index: Ra= 71.9**

R1 =69.4 R2 =80.7 R3 =89.1 R4 =68.4 R5 =66.6 R6 =70.8 R7 =80.6  
 R8 =49.8 R9 =-21.8 R10=53.2 R11=61.5 R12=40.7 R13=71.3 R14=93.3  
 R15=63.9

**Photo Parameters**

Flux: 223.20lm Effi.: 74.4lm/W RadiantPower: 739.3mW

**Ele. Parameters**

Voltage:U=218.0V

Current:I=0.025A

Power:P= 3.0W

Power Factor:PF=0.610

**Instrument state**

IntgeTime: 238.855ms VPeak: 13597

VDark: 1317

Scan Range: 380-780nm

Spec No.	Date	Page	Ver.
/	Feb/18/2016	6/7	A2

## Connection

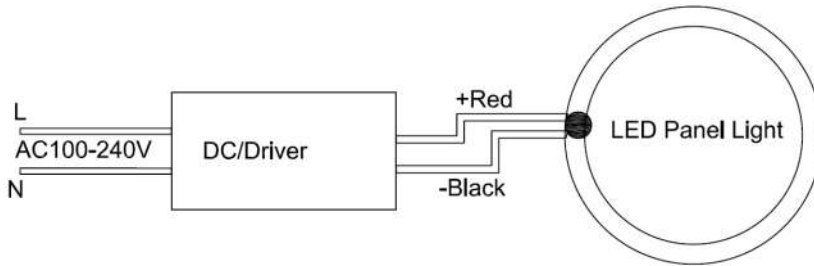

## Installation Instruction

◆ **Attention:** Before installation, power must be cut off to keep people safe.

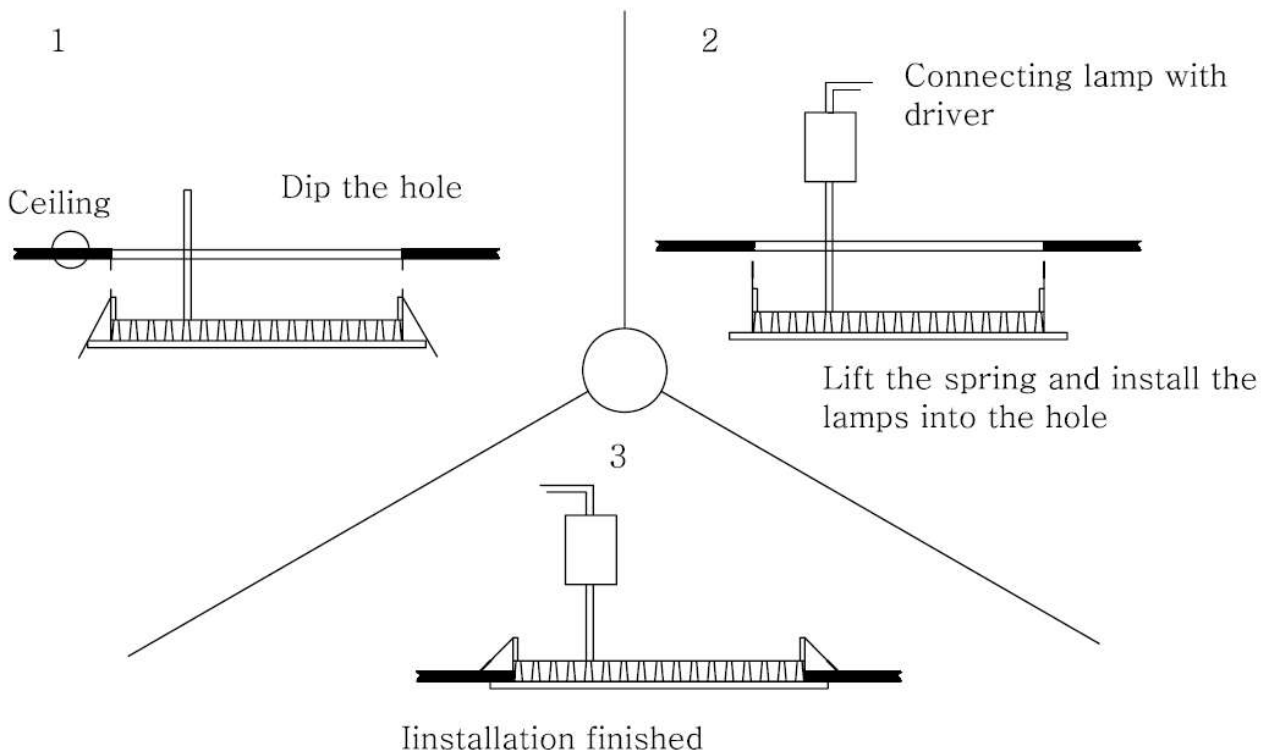

Notice: turn off the light before install or uninstall

Spec No.	Date	Page	Ver.
/	Feb/18/2016	7/7	A2

## ■ The view of package

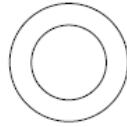

Panel light

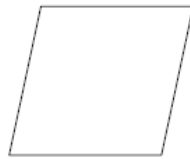

PE bag

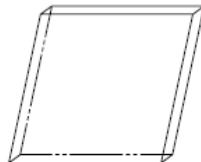

Inner box

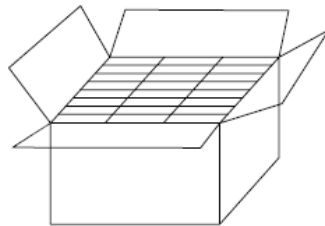

60pcs/Carton

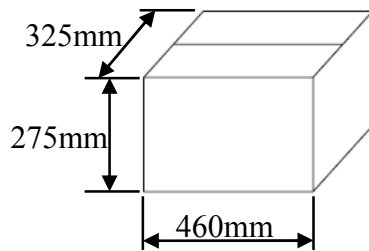

Sealed carton

Size of panel(mm)	∅ 90*12mm
Hole size(mm)	∅ 75mm
Inner box size	L*W*H: 120x28x150mm
Carton size	L*W*H: 460x325x275mm
Packing quantity	60pcs
Net weight	4.86kg
Gross weight	6.91kg